

Large Telemetry Compressive Load Cell TC-3.0-LG

DLM's Telemetry Compressive Load Cells can be used independently or in combination as part of weighing platforms.

They range from 100t to 300t and manufactured using high grade stainless steel, making these load cells particularly suited to rugged environments and the hire industry. Bespoke size compressive load cells can be designed upon request. Some applications include: tank weighing, hydraulic lifting operations, vessel weighing and certification.



Dimensional Data

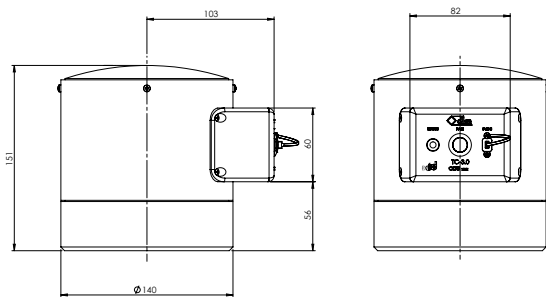

Features:

- 2.4GHz licence free frequency
- Ability to transmit to unlimited handheld displays
- Up to 800m range (line of sight)
- Remote power on/off
- Sleep mode for battery conservation
- Use the TW-3.0 Handheld to totalise load readings from multiple compressive load cells

Load Capacity (Tonnes)	Description	Part Number	Accuracy (% FRO)	Proof Load (% Load Capacity)	Weight (kg)	Resolution (kg)
100	Dome Top	0001-1372	<±0.5	150	14	100
150	Dome Top	0001-1373	<±0.5	150	14	100
200	Dome Top	0001-1374	<±0.5	150	14	100
300	Dome Top	0001-1375	<±0.5	150	14	100

Specification

Battery:	1 x 3.7V Li-Po rechargeable
Battery Life:	700 hours continuous (2 years non-operational)
Charger:	Supplied with USB charger
Operating Temperature:	-20°C to +60°C
Handheld Display:	One or more TW-3.0 display
Frequency:	2.4GHz
Range:	Up to 800m range (line of sight)
Loadcell Material:	Stainless steel
Bridge Resistance:	1000Ω
Saddle Options:	Dome saddle
Calibration:	Supplied with calibration, proof load and test certificates to traceable to UKCA BS EN ISO 7500-1 2018
Packaging:	Packaged in rugged storm/ watertight peli case.
Compatible With:	TW-3.0-T handheld display / Custom built display / Centre of gravity display
Optional extras:	100-300t load saddle. Part number 0001-1227
Approvals:	UKCA, CE, FCC and IC tested and compliant